



**CARTRIDGE TANK,
FILTERS, CANISTER,
AND ACCESSORIES**

HYDRO-CURE®

Cartridge Tank



Order No. C3100C



Order No. C3100H

Clack's Hydro-Cure® Cartridge Tank is injection molded using glass-filled composite material. Clack's design provides a continuous seamless tank for higher strength and pressure capabilities.

Hydro-Cure® is a federally registered trademark of Clack Corporation.

FEATURES:

- For water filtration applications
- 4 different micron melt blown filters
- 2 different micron melt blown/carbon filters
- 4 different micron pleated filters
- 2 canisters – with or without mid plate
- 5-year warranty

MATERIAL OF CONSTRUCTION:

- Glass filled composite

OPERATING PARAMETERS:

- Pressure Range: 20–125 psi / 1.4–8.6 bar
- Temperature Range: 40–110°F / 4–43°C

MADE IN THE USA



1191 In/Out Head 1.320



Order No. D1400-04

Vertical Elbow Union Adapter Asy



Order No. V3007-21

Bypass



Order No. V3006

ORDERING INFORMATION

CARTRIDGE TANK

ORDER NUMBER	DESCRIPTION	QUANTITY PER CARTON
C3100C	Cartridge Tank Assembly Black	1
C3100H	Cartridge Tank Assembly CWS Dark Gray	1

INDIVIDUAL PARTS

DRAWING NUMBER	ORDER NUMBER	DESCRIPTION
1	C3001	CT Nut
2	C3002	CT Cap 2.5 NPSM
3	C3022	O-Ring 370
4	C3004	CT 1.320 Center Adapter
5	C3000	CT Housing Body Black
	C3000-H	CT Housing Body CWS Dark Gray
6	C3003	CT Tank Base
7	C2260	WS1 Elbow 3/4 JG QC
8	C3039	Cartridge Tank Service Wrench
9	Cartridge Tank Filters Sold Separately	

IN/OUT HEAD, FITTINGS, AND ACCESSORIES

ORDER NUMBER	DESCRIPTION	QUANTITY PER CARTON
D1400-04	1191 In/Out Head (1.320" Short Riser Pilot)	24
V3006	Bypass	24
V3007	1" PVC Male NPT Elbow Assembly	24 sets
V3007-01	3/4" x 1" PVC Solvent Elbow Assembly	24 sets
V3007-02LF	1" Brass Sweat Straight Assembly LF	24 sets
V3007-03LF	3/4" Brass Sweat Straight Assembly LF	24 sets
V3007-04	1" Composite Plastic Male NPT Straight Assembly	24 sets
V3007-05	1.25" Composite Plastic Male NPT Straight Assembly	24 sets
V3007-06	1" Plastic Male BSPT Straight Assembly	24 sets
V3007-07	1.25" & 1.5" PVC Solvent Straight Assembly	24 sets
V3007-08	1.25" Plastic Male BSPT Straight Assembly	24 sets
V3007-09LF	1.25" & 1.5" Brass Sweat Straight Assembly LF	24 sets
V3007-12	3/4" SharkBite® QC Straight Assembly	24 sets
V3007-13	1" SharkBite® QC Straight Assembly	24 sets
V3007-14	3/4" Plastic Male BSPT Straight Assembly	24 sets
V3007-15	3/4" John Guest® QC Elbow Assembly	24 sets
V3007-16	1" PVC Male BSPT Elbow Assembly	24 sets
V3007-17	1" John Guest® QC Straight Assembly	20 sets
V3007-18	3/4" Plastic Male NPT Straight Assembly	24 sets
V3007-19	3/4" John Guest® QC Straight Assembly	24 sets
V3007-20	1" John Guest® QC Elbow Assembly	16 sets
V3007-21	Vertical Elbow Union Adapter Assembly	16 sets
V3007-22LF	1" Brass Press/Sweat Straight Assembly	24 sets

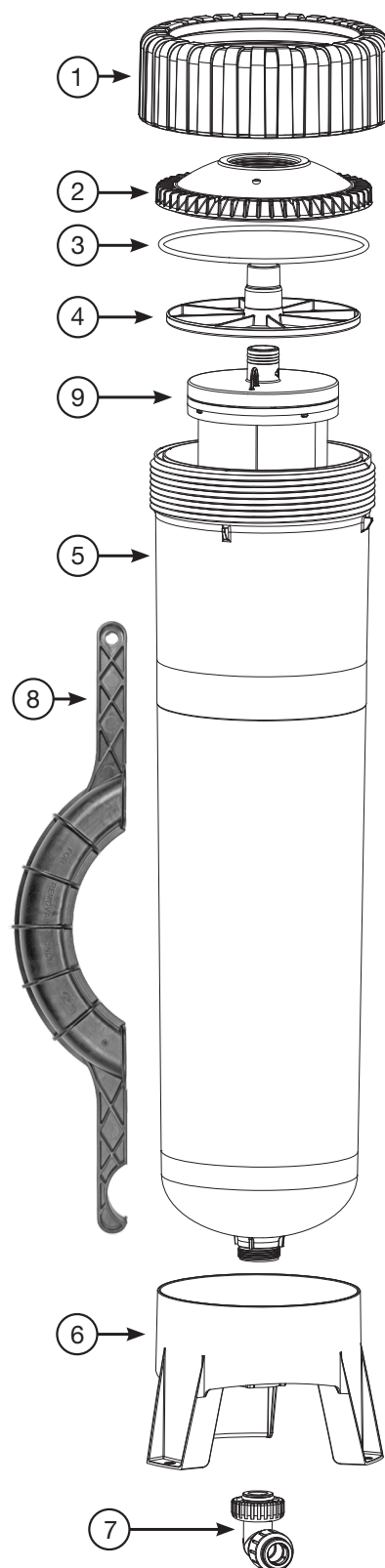

Certified to NSF/ANSI 42, NSF/ANSI/CAN 61, and NSF/ANSI/CAN 372.
Visit www.nsf.org to view our Certified Products.

HYDRO-CURE[®]

CARTRIDGE TANK

INSTALLATION GUIDE

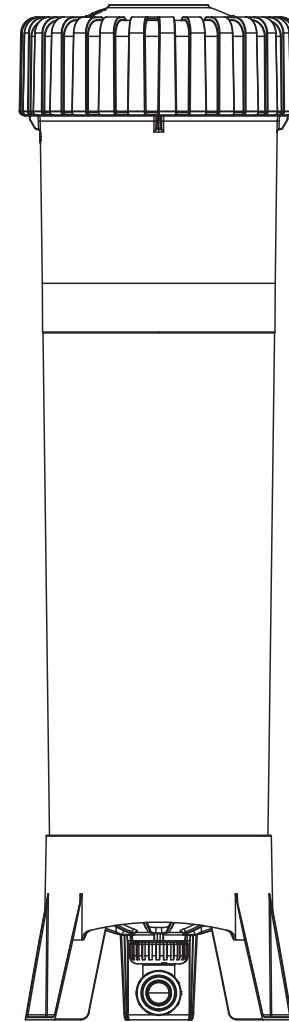

ORDER NUMBERS:
C3100C
C3100H

**WARNING: USE ONLY SILICONE-BASED LUBRICANTS
ON ALL CLACK CORPORATION COMPONENTS**

HYDROCARBONS WILL DAMAGE COMPONENTS THAT CONTAIN O-RINGS AND OR PLASTIC. THIS CAN CAUSE LEAKS OR BREAKAGE. DO NOT USE LUBRICANTS THAT CONTAIN HYDROCARBONS SUCH AS VASELINE®/ PETROLEUM JELLY, WD-40®, ETC. DO NOT USE CLACK CONTROL VALVE PRODUCTS ON WATER SUPPLIES THAT CONTAIN HYDROCARBONS, SUCH AS BENZENE, GASOLINE, KEROSENE, ETC.

OPERATION

Maximum Pressure: 125 PSI • Maximum Temperature: 110°F

DIMENSIONS

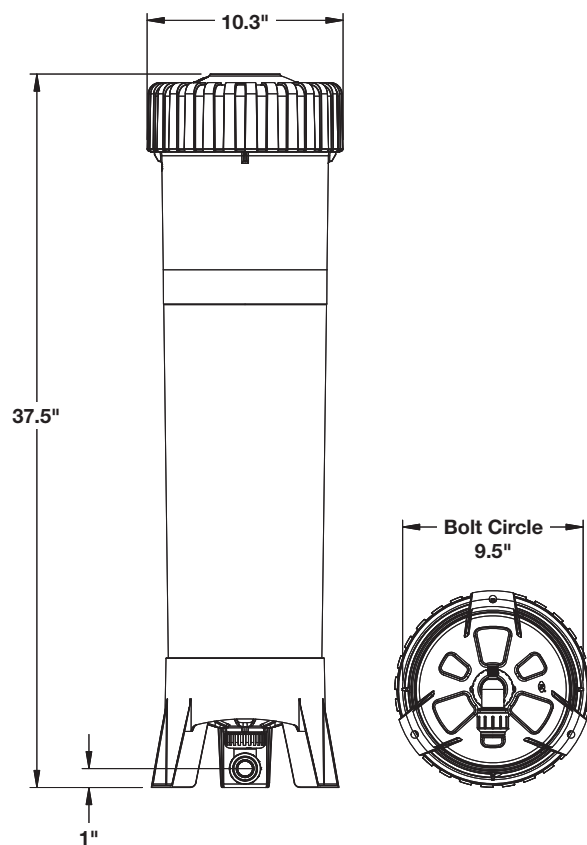

PARTS

Cartridge Tank Parts

Drawing Number	Order Number	Description	Qty.
1	C3001	CT Nut	1
2	C3002	CT Cap 2.5 NPSM	1
3	C3022	O-Ring 370	1
4	C3004	CT 1.320 Center Adapter	1
5	C3000	CT Housing Body Black	1
	C3000-H	CT Housing Body CWS Dark Gray	
6	C3003	CT Tank Base	1
7	V3007-15*	WS1 Fitting JG QC Elbow Assembly	1

*includes two fittings

Optional Parts - Sold Separately

Drawing Number	Order Number	Description	Qty.
8	V3006	WS1 Bypass Assembly	1
9	V3007-21	Vertical Elbow Union Adapter Assembly	1
10	D1400-04	1191 1.320	1
11	See back page for Filters		1

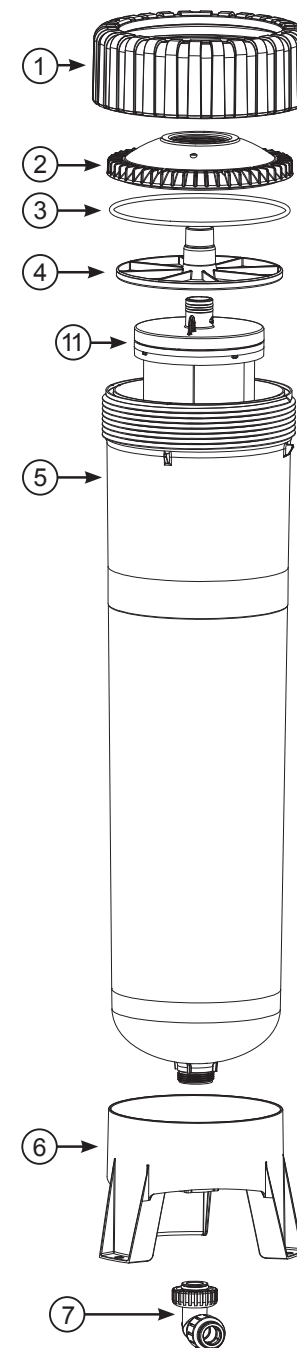
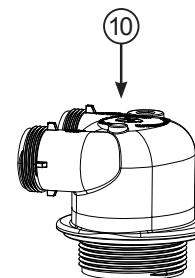
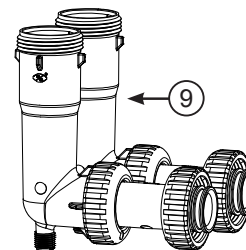
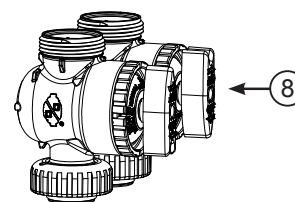

Cartridge Tank Melt Blown Sediment Filters



Dual O-rings in upright position for Clack Cartridge Tank.



Dual O-rings in the downward position for other cartridge tanks on the market.

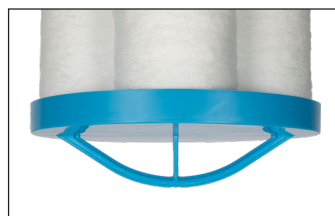

Opposite end of filter.

Clack Cartridge Tank dual gradient melt blown sediment filters are manufactured on state-of-the-art production equipment using a computer-controlled process to ensure reliability and performance.

Dual gradient depth filtration is achieved with our technically advanced die system. This design allows us to create two distinct filter zones. Larger particles are trapped and filtered out in the first zone and the smaller particles are trapped in the second zone. The tighter matrix of the inner zone also provides exceptional strength and functions as a self-supporting core, eliminating the need for a separate center core. The dual gradient design allows for optimum dirt holding capacity and reduced pressure loss.

Clack Cartridge Tank dual gradient sediment filters are made of polypropylene resin meeting FDA regulation. No binders, lubricants, or anti-static agents are used in our manufacturing process. The inert polypropylene resin provides exceptional chemical compatibility to handle a wide range of process fluids.

Clack Cartridge Tank dual gradient sediment filters are available in three different micron ratings.

The four filter posts give an additional 56% more filtration surface area than an equivalent 30" length solid filter on the market.

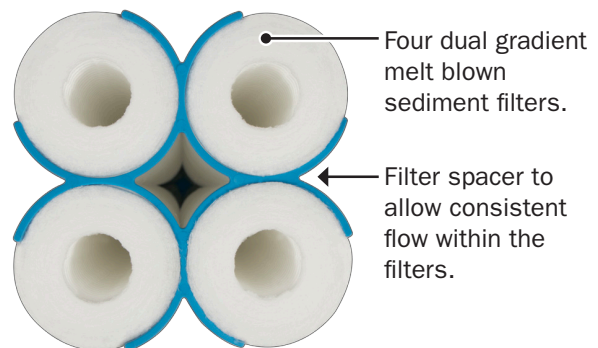

ORDER NUMBER	DESCRIPTION	DUAL GRADIENT NOMINAL MICRON RATINGS*	QUANTITY PER CARTON	QUANTITY PER MASTER CARTON
C3400-MB2501	CT Sediment Filter MB 25/01 MIC	25 Micron/1 Micron	1	6
C3400-MB2505	CT Sediment Filter MB 25/05 MIC	25 Micron/5 Micron	1	6
C3400-MB5005	CT Sediment Filter MB 50/05 MIC	50 Micron/5 Micron	1	6
C3400-MB7525	CT Sediment Filter MB 75/25 MIC	75 Micron/25 Micron	1	6

*Hydro-Cure® sediment filters are designed for sediment reduction from potable water. These cartridges will not remove or kill bacteria and should not be used on microbiologically unsafe water.

Hydro-Cure® is a federally registered trademark of Clack Corporation.

See back page for flow data.

Cartridge Tank Melt Blown Sediment Filters

Flow rate testing was conducted by the manufacturer, Clack Corporation. Results may vary depending on water pressure, inlet water quality, flow rate, and system design. The flow rate is based on the initial use of a clean, new filter.

Testing verified using Cartridge Tank, In/Out Head, Bypass, and 1" fittings.

FILTER PERFORMANCE

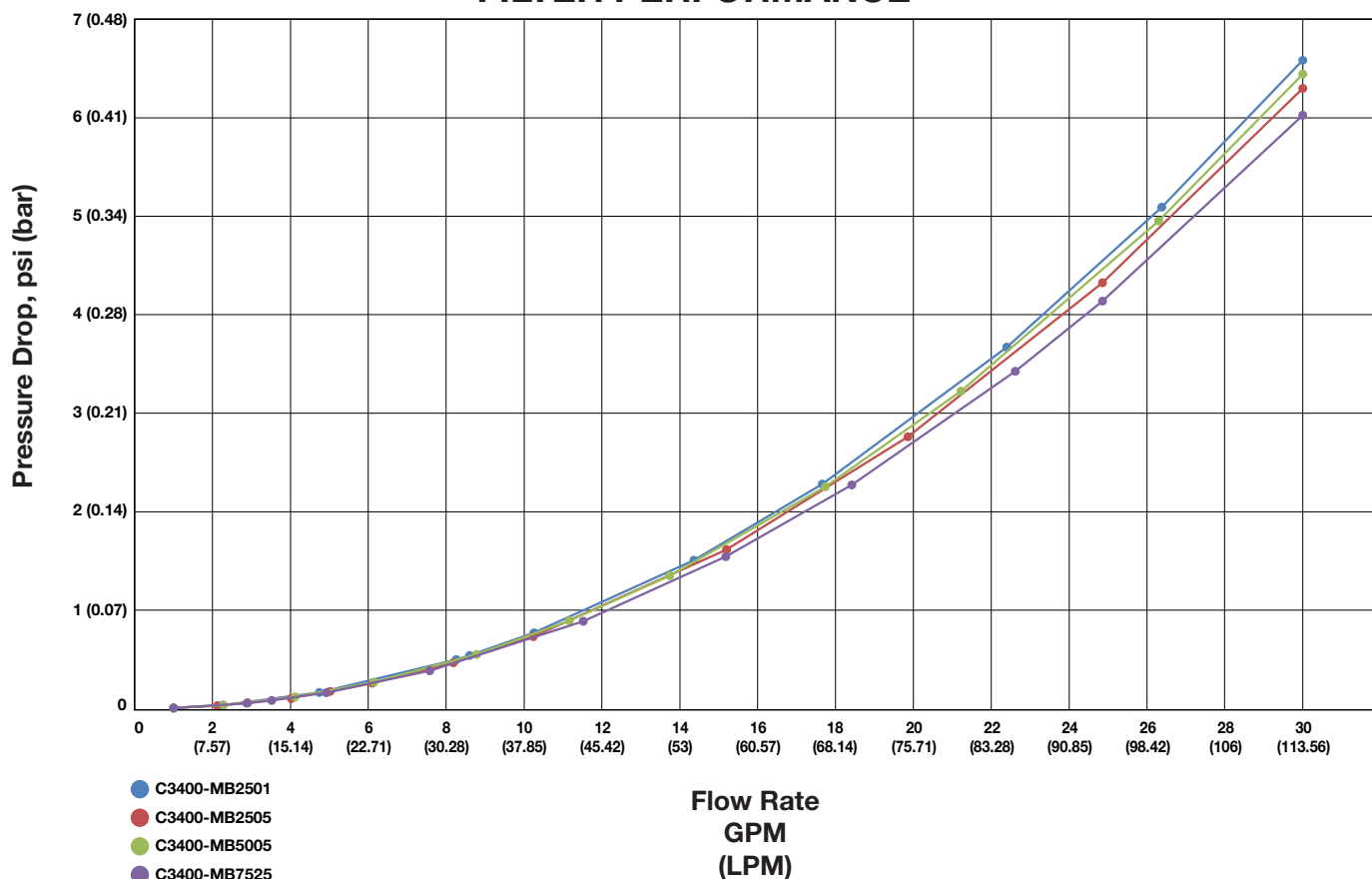

Certified to NSF/ANSI 42 and NSF/ANSI/CAN 372.
Visit www.nsf.org to view our Certified Products.

Cartridge Tank Sediment/CTO Carbon Filters



Dual O-rings in upright position for Clack Cartridge Tank.



Dual O-rings in the downward position for other cartridge tanks on the market.

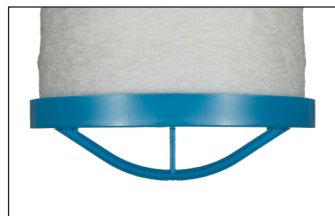

Opposite end of filter.

Clack Cartridge Tank Sediment/CTO Carbon Filters are an economical way to remove sediment and Chlorine, Taste, and Odor (CTO).

These filters are manufactured on state-of-the-art production equipment using a computer-controlled process to ensure reliability and performance.

The dual gradient design allows for optimum dirt holding capacity and reduced pressure loss. With two distinct filter zones, larger sediment particles are trapped and filtered out in Zone 1, and smaller particles are trapped in the carbon block of Zone 2. The tighter matrix of Zone 2 also provides exceptional strength, eliminating the need for a separate center core.

Cartridge tank filters are available with two different micron ratings for Zone 2.

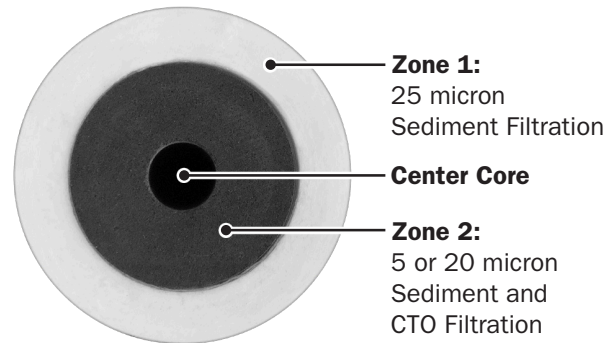

ORDER NUMBER	DESCRIPTION	DUAL GRADIENT NOMINAL MICRON RATINGS*	QUANTITY PER CARTON
C3400-CT05	CT CTO Sediment/Carbon 25/05 MIC	25 Micron/5 Micron	1
C3400-CT020	CT CTO Sediment/Carbon 25/20 MIC	25 Micron/20 Micron	1

*Hydro-Cure® sediment/carbon filters are designed for sediment and Chlorine, Taste, and Odor (CTO) reduction from potable water. These cartridges will not remove or kill bacteria and should not be used on microbiologically unsafe water. Hydro-Cure® is a federally registered trademark of Clack Corporation.

See back page for flow data.

Cartridge Tank Sediment/CTO Carbon Filters

Flow rate testing was conducted by the manufacturer, Clack Corporation. Results may vary depending on water pressure, inlet water quality, flow rate, and system design. The flow rate is based on the initial use of a clean, new filter.

Testing verified using Cartridge Tank, In/Out Head, Bypass, and 1" fittings.

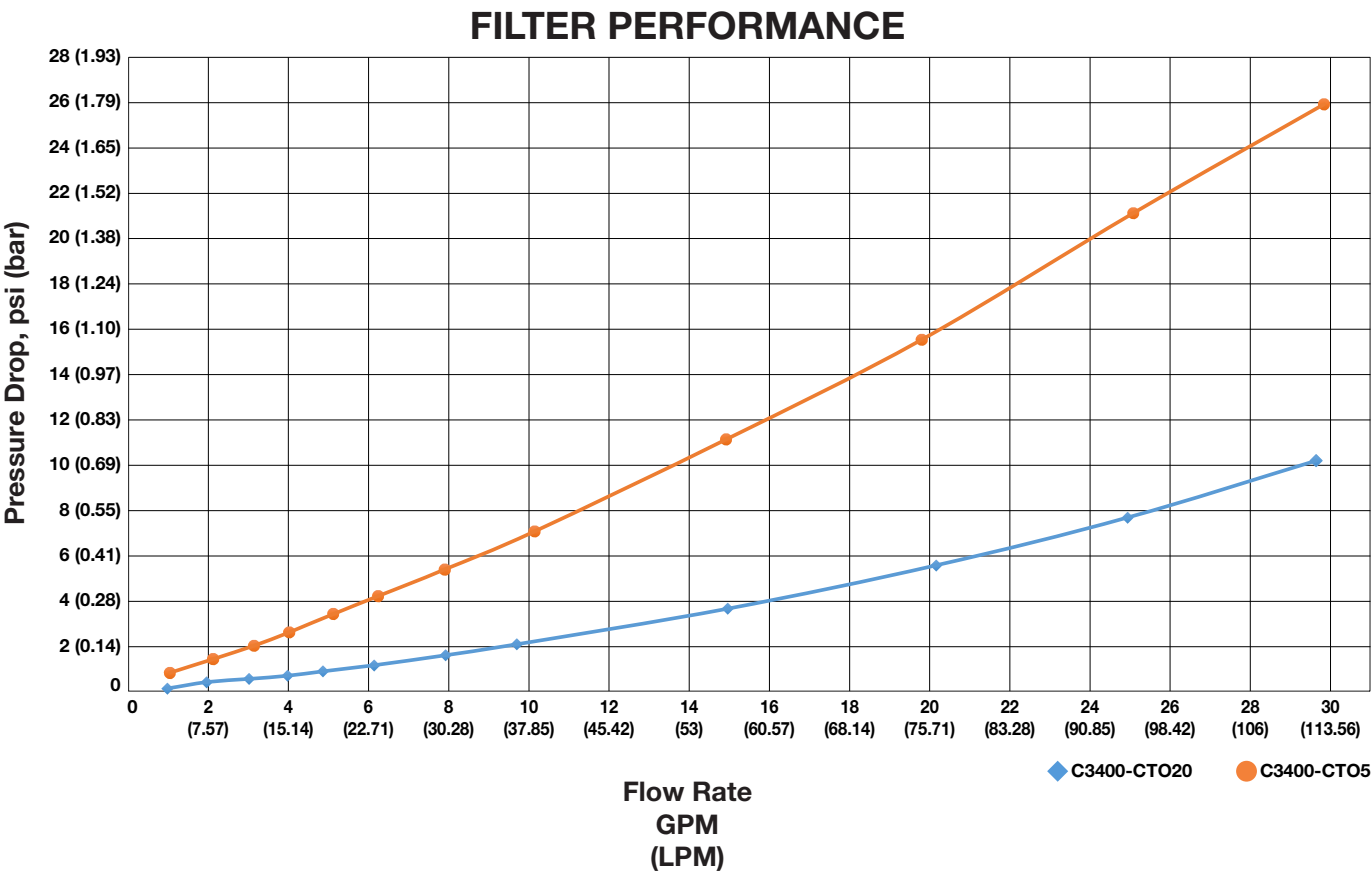

Certified to NSF/ANSI 42 and NSF/ANSI/CAN 372.
Visit www.nsf.org to view our Certified Products.

Cartridge Tank Pleated Sediment Filters

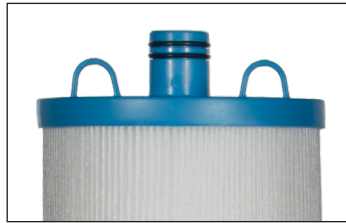

Dual O-rings in upright position for Clack Cartridge Tank.



Dual O-rings in the downward position for other cartridge tanks on the market.



Opposite end of filter.

Clack Cartridge Tank Pleated Sediment Filters deliver high-performance filtration with a flexible design that adapts to a variety of systems.

With dual O-ring configurations, these filters fit securely in Clack Cartridge Tanks, ensuring easy installation and a reliable seal.

Available in 1, 5, 20, and 50-micron ratings, they offer precision filtration tailored to your specific water quality needs.

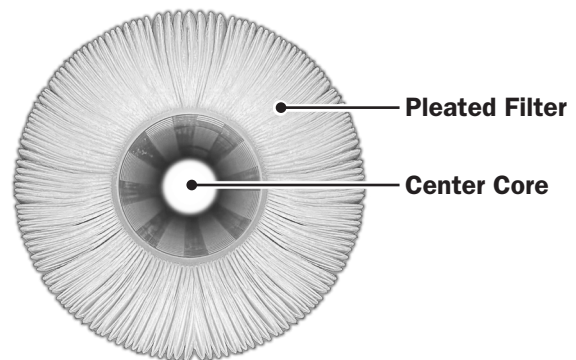

ORDER NUMBER	DESCRIPTION	NOMINAL MICRON RATING	QUANTITY PER CARTON	QUANTITY PER MASTER CARTON
C3400-PL01	CT Sediment Filter PL 01 MIC	1 Micron	1	6
C3400-PL05	CT Sediment Filter PL 05 MIC	5 Micron	1	6
C3400-PL20	CT Sediment Filter PL 20 MIC	20 Micron	1	6
C3400-PL50	CT Sediment Filter PL 50 MIC	50 Micron	1	6

Cartridge Tank Pleated Sediment Filters

Flow rate testing was conducted by the manufacturer, Clack Corporation. Results may vary depending on water pressure, inlet water quality, flow rate, and system design. The flow rate is based on the initial use of a clean, new filter.

Testing verified using Cartridge Tank, In/Out Head, Bypass, and 1" fittings.

FILTER PERFORMANCE

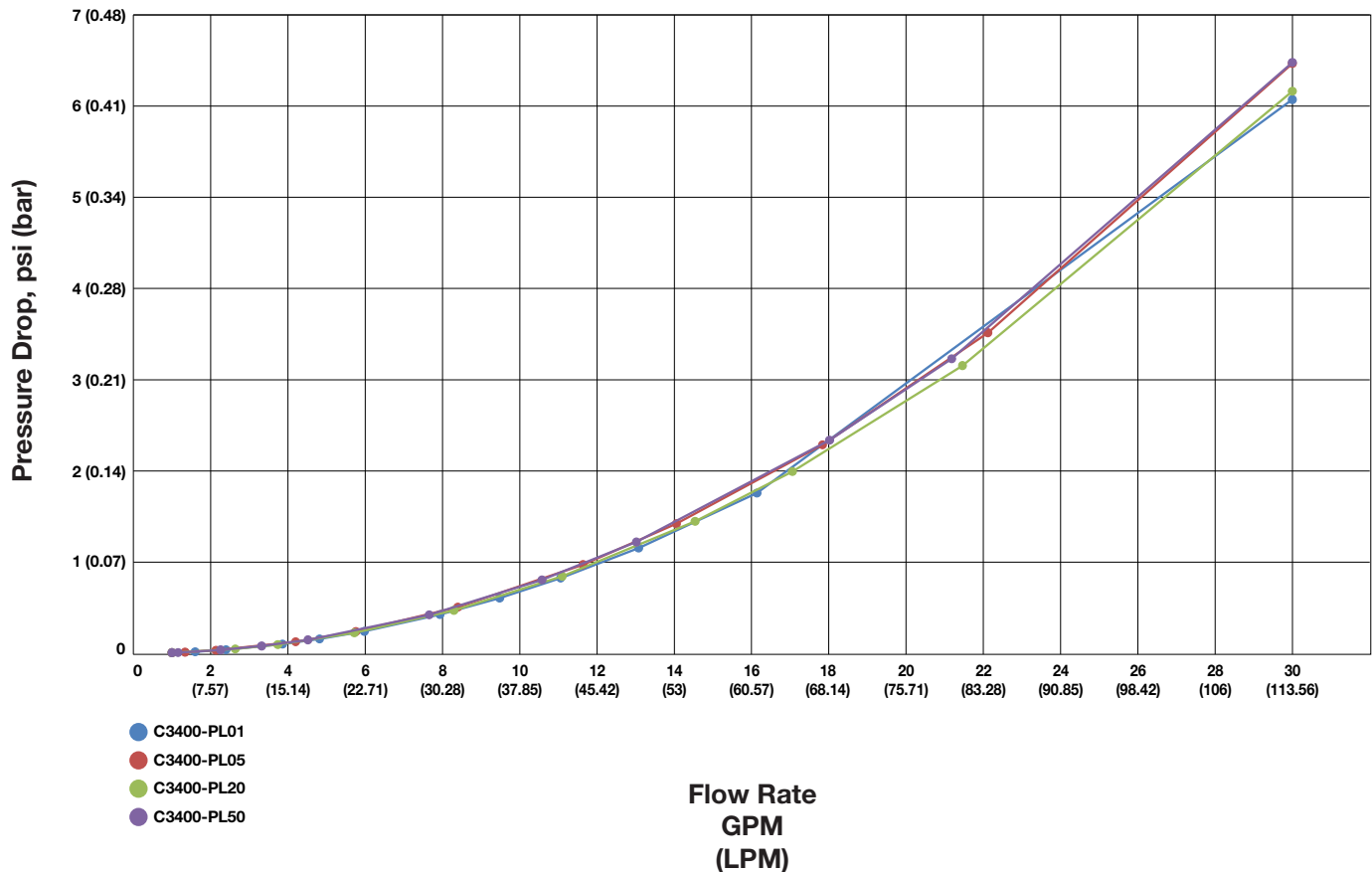

HYDRO-CURE®

Cartridge Tank Canister



Dual O-rings in upright position for Clack Cartridge Tank.



Dual O-rings in the downward position for other cartridge tanks on the market.



Opposite end of canister.

Clack Cartridge Tank Canister is designed to deliver superior filtration performance and system versatility with minimal maintenance.

Engineered with precision slot sizes of 0.010"–0.013", it ensures consistent flow and contaminant capture.

Whether you're using the mid-plate model for enhanced media separation or the standard version for simplified use, the canister offers flexibility to suit a variety of system configurations — all while maintaining high flow rates and low-pressure drop.



Bottom Canister Cap

Bottom Plate
(Same plate used on both Canister Caps)

ORDER NUMBER	DESCRIPTION	SLOT SIZES		QUANTITY PER CARTON	QUANTITY PER MASTER CARTON
		TOP/BOTTOM PLATE	MID PLATE		
C3400-RF	CT CANISTER ASY NO MID-PLATE	0.010" – 0.013"	Not Applicable	1	6
C3400-RFM	CT CANISTER ASY W/MID-PLATE	0.010" – 0.013"	0.010" – 0.013"	1	6

Hydro-Cure® is a federally registered trademark of Clack Corporation.

See back page for canisters media amount.

Cartridge Tank Canister

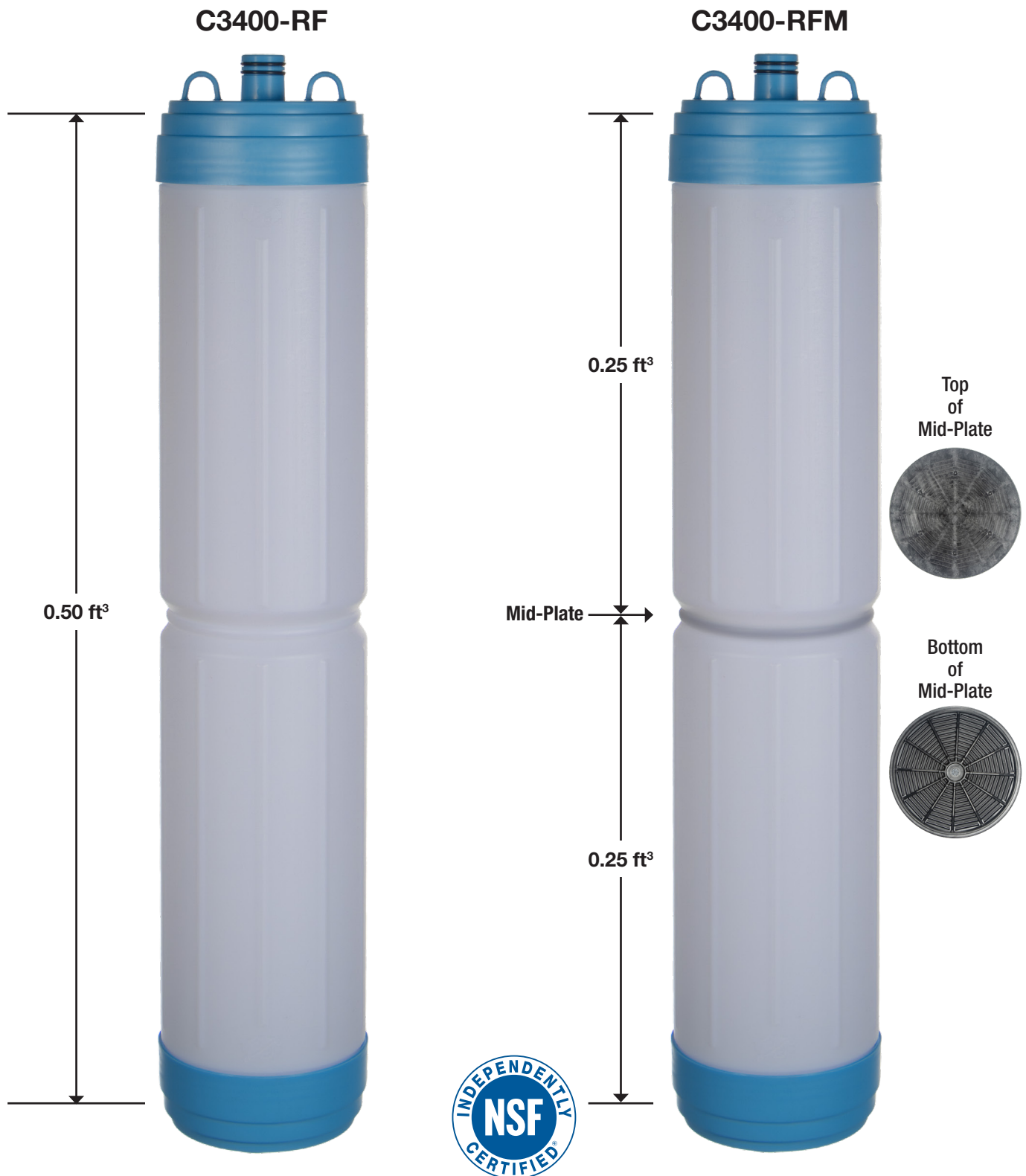

Certified to NSF/ANSI 42 and NSF/ANSI/CAN 372.
Visit www.nsf.org to view our Certified Products.

CARTRIDGE CANISTER MEDIA AMOUNT

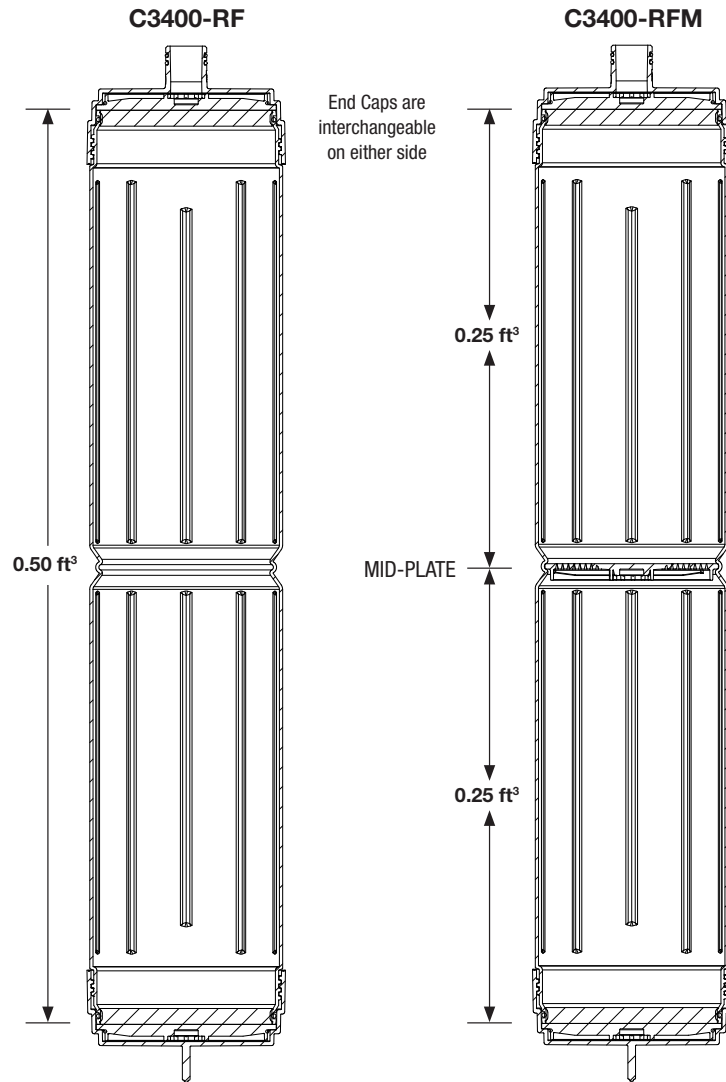

TOP PLATE SLOT SIZE: 0.010 - 0.013"
MID-PLATE SLOT SIZE: 0.010 - 0.013"
BOTTOM PLATE SLOT SIZE: 0.010 - 0.013"

HYDRO-CURE[®] CARTRIDGE TANK CANISTER GUIDE

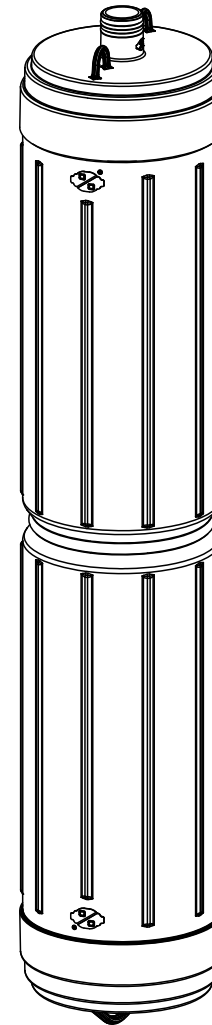

**ORDER NUMBER:
C3400-RF/C3400-RFM**

**WARNING: USE ONLY SILICONE-BASED LUBRICANTS
ON ALL CLACK CORPORATION COMPONENTS**

HYDROCARBONS WILL DAMAGE COMPONENTS THAT CONTAIN O-RINGS AND OR PLASTIC. THIS CAN CAUSE LEAKS OR BREAKAGE. DO NOT USE LUBRICANTS THAT CONTAIN HYDROCARBONS SUCH AS VASELINE®/ PETROLEUM JELLY, WD-40®, ETC. DO NOT USE CLACK CONTROL VALVE PRODUCTS ON WATER SUPPLIES THAT CONTAIN HYDROCARBONS, SUCH AS BENZENE, GASOLINE, KEROSENE, ETC.

OPERATION

Maximum Pressure: 125 PSI • Maximum Temperature: 110°F

CANISTER FLOW

Downflow Service

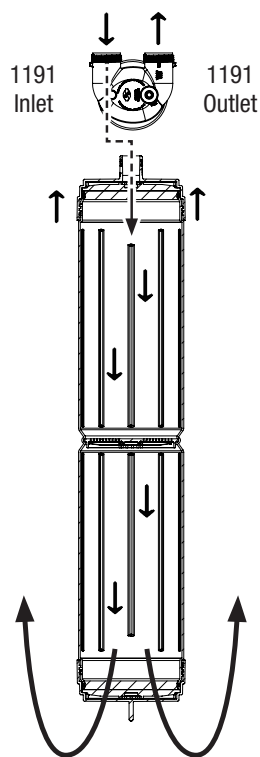

Upflow Service

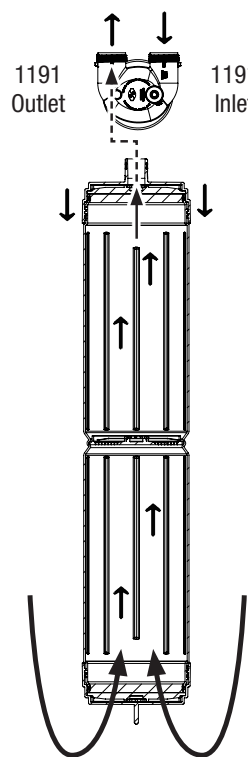

DOWNFLOW SERVICE BYPASS HANDLE ORIENTATION:

To have the arrow handles match the service flow, handles must be reversed.

MID-PLATE ORIENTATION:

End Caps should be oriented to allow water flow from the flat side of mid-plate to the grooved side.

PARTS

Drawing Number	Order Number	Description	C3400-RF	C3400-RFM
1	C3023	CT CANISTER BODY NO MID_PLATE	1	
	C3023-M	CT CANISTER BODY W/MID-PLATE		1
2	C3038	O-RING -253	2	2
3	C3024-01	CT CANISTER TOP CAP ASY	1	1
4	C3025-01	CT CANISTER BOTTOM CAP ASY	1	1
5	C3015	O-RING -122	2	2
6	C3041	CT CANISTER FOAM FILTER	2	2

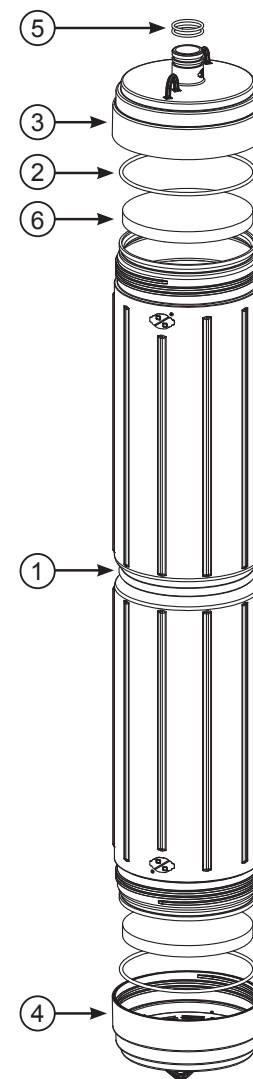

Note: The C3041 is an optional foam filter for use with fine mesh resin or finer mesh medias. The foam filters help to keep a packed bed.